



Galton Road, Cambridge, CB3 0YW

CHEFFINS

Galton Road

Cambridge,
CB3 0YW

ZERO DEPOSIT OPTION AVAILABLE. A new 2 bedroom first floor apartment forming part of this select development situated off Huntingdon Road. The accommodation comprises entrance hall with store cupboards, open plan living room/kitchen with balcony off, principle bedroom with en-suite shower room, 1 further double bedroom and bathroom. Further benefits include allocated parking space and secure bicycle store. Unfurnished. Available from 04/06/2026. EPC: A and Council Tax Band: TBC.

LOCATION

Darwin Green is a select development situated off Huntingdon Road within the Castle ward of Cambridge and lies approximately 1 mile from Cambridge's historic city centre. The development is convenient for access to the A14 and M11 and Cambridge Science Park approximately 3 miles distant. A good range of local amenities including a supermarket, shops, bars, restaurants and a primary school can be found at the nearby Eddington development.

2 2 1

£1,850 Per Month





ENTRANCE HALL

built in cupboard with double doors and doors to open plan living room/kitchen, bedrooms and bathroom off.

OPEN PLAN LIVING ROOM/KITCHEN

kitchen fitted with base and wall units, work tops, sink and integrated appliances including oven, gas hob with extractor hood above, fridge freezer, dishwasher and washer dryer. Living area with built in cupboard housing gas central heating boiler and patio doors to:

BALCONY

composite decking and railings.

BEDROOM 1

fitted double wardrobe with mirrored doors, window to front aspect and door to:

EN-SUITE SHOWER ROOM

shower enclosure, wc, wash basin with mirror above and heated towel rail.

BEDROOM 2

fitted double wardrobe with mirrored doors and window to front aspect.

BATHROOM

shower over bath with glass shower screen, wc, wash basin with mirror above and heated towel rail.

LETTING AGENT NOTES

MATERIAL INFORMATION

Holding Deposit - £426

Deposit - £2134

EPC - A

Council Tax - New build; rate not yet available

Square Footage - 745

Property Type - Second floor apartment

Property Construction - Bricks and mortar

Parking - Allocated parking space

Electric Supply - Mains Supply

Gas Supply - Mains Supply

Water Supply - Mains Supply

Sewerage - Mains

Heating source - Gas Boiler & Radiators

Broadband Connected - Ready for connection

Broadband Type - Fibre to the cabinet

Mobile Signal/Coverage - New build; information not yet available

Flood risk - Very low

"Lomond, on behalf of Lloyds Living, part of Lloyds Banking Group, operates a growing portfolio of more than 3,000 professionally managed homes for rent, improving access to good value, quality, sustainable housing across the UK. Lloyds Living helps to support investment into local communities by building and renting homes that people want, in the places they are needed."

"Property features and specifications may vary on a plot-by-plot basis. Whilst every attempt has been made to ensure accuracy, all measurements are approximate and not to scale. Computer-generated images, floor plans, and photos (CGIs) are for illustrative purposes only and may not represent the final design or finish of the property. For further information on layouts and specifications, please speak to your Lloyds Living representative."



Approximate Area = 742 sq ft / 68.9 sq m
For identification only - Not to scale

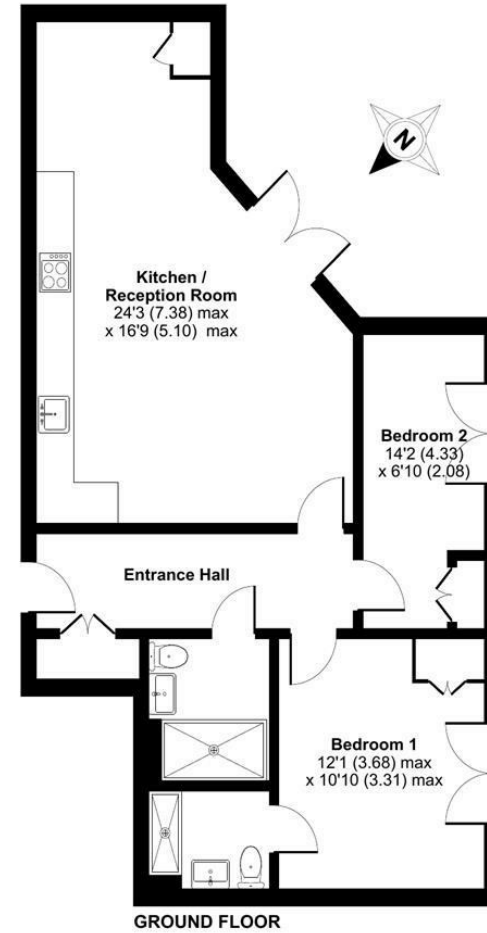

Energy Efficiency Rating		Current	Potential
Very energy efficient - lower running costs			
012 (plus) A	(91-91)	93	93
B	(81-91)		
C	(69-80)		
D	(55-68)		
E	(39-54)		
F	(21-38)		
G	(1-20)		
Not energy efficient - higher running costs			
England & Wales		EU Directive 2002/91/EC	

Floor plan produced in accordance with RICS Property Measurement Standards incorporating International Property Measurement Standards (IPMS2 Residential). © nichicom 2025. Produced for Lomond Property (Lettings). REF: 1344691

Agents note:
For more information on this property please refer to the Material Information Brochure on our website.

Clifton House, 1-2 Clifton Road, Cambridge, Cambridgeshire, CB1 7EA | 01223 271916 | cheffins.co.uk

IMPORTANT: we would like to inform prospective purchasers that these sales particulars have been prepared as a general guide only. A detailed survey has not been carried out, nor the services, appliances and fittings tested. Room sizes should not be relied upon for furnishing purposes and are approximate. If floor plans are included, they are for guidance only and illustration purposes only and may not be to scale. If there are any important matters likely to affect your decision to buy, please contact us before viewing the property.

